

BANFIELD INDUSTRIAL PARK

10,405 Sq Ft Warehouse/Distribution

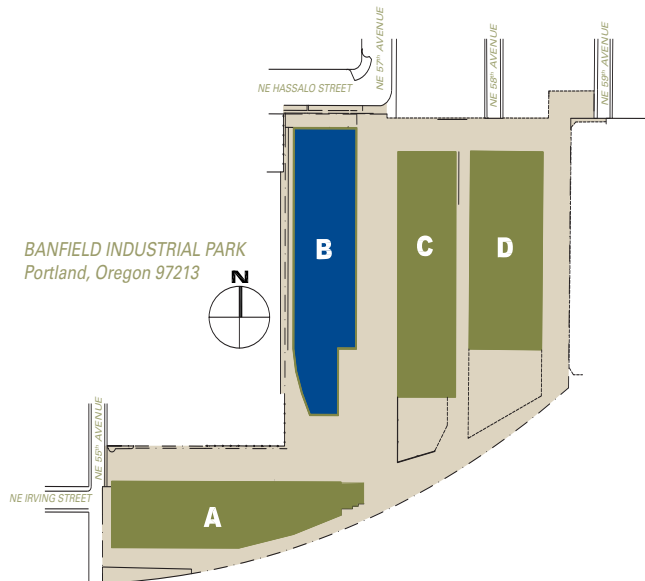

LOCATION	Building B 5636 NE Hassalo Street Portland OR 97213
TOTAL SQ FT	10,405 SF
OFFICE SQ FT	706
DOCK HIGH DOORS	2
DRIVE-IN DOORS	1
CLEAR HEIGHT	16'
FEATURES	Light rail station located within one block; fenced outside storage, end cap
MONTHLY RATE	\$0.40/sqft - Shell \$0.75/sqft - Office NNN



LEASING CONTACT	Sam Briggs samb@pactrust.com 503-624-6300
	Dave Hicks daveh@pactrust.com 503-624-6300

BUILDING KEY

A.	700 NE 55th Avenue	
B.	5622 NE Hassalo Street	
C.	910 NE 57th Avenue	All addresses are
D.	920 NE 58th Avenue	Portland, OR 97213

BANFIELD INDUSTRIAL PARK

Building B • 5636 NE Hassalo Street • Portland OR 97213

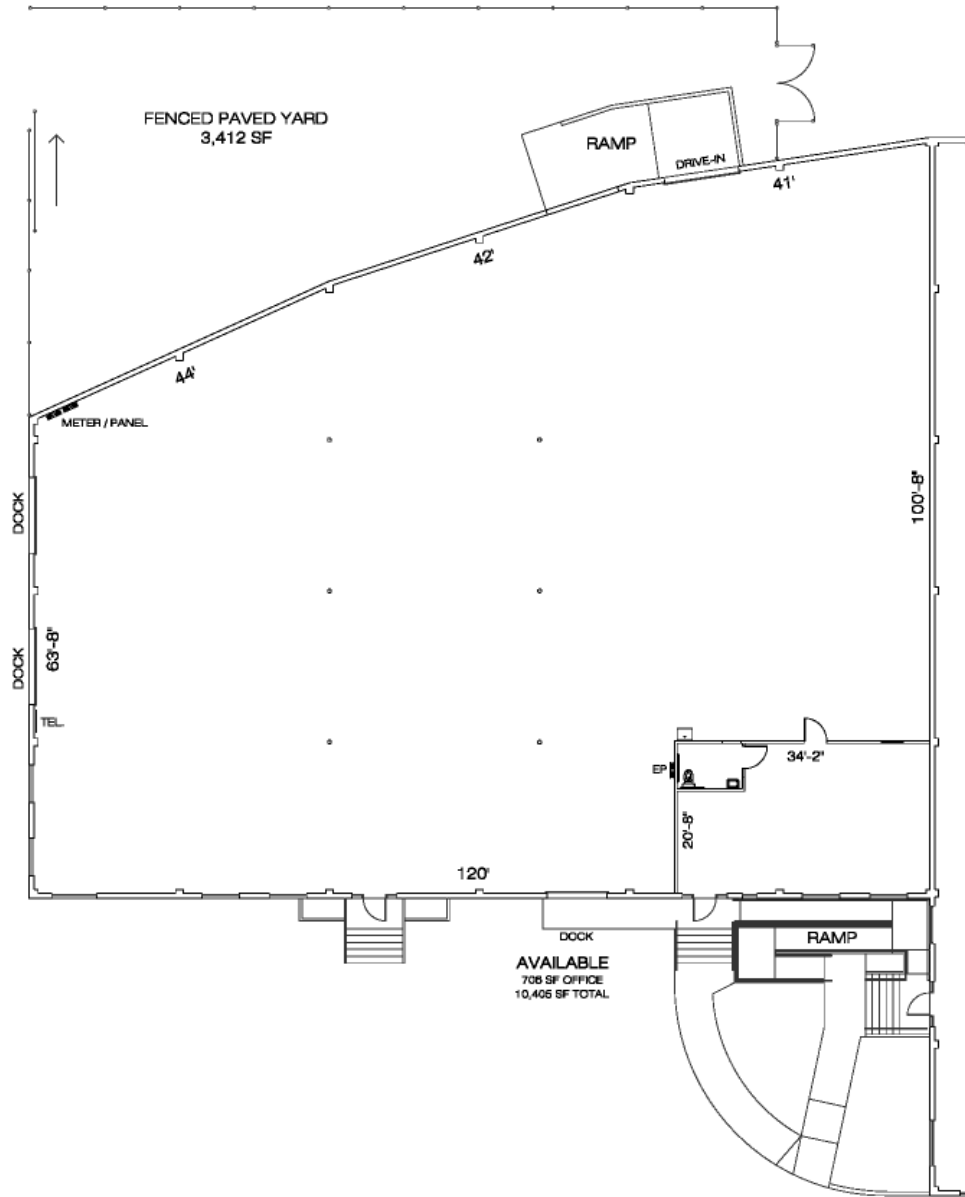

PACTRUST

Pacific Realty Associates, L.P.

15350 SW Sequoia Parkway, Suite 300, Portland OR 97224 • 503-624-6300 • www.pactrust.com

The square footage and rates quoted herein are subject to change. PacTrust can only guarantee square footage and rates with a signed lease agreement.