

FIVE OAKS WEST BUSINESS PARK

6,398 Sq Ft Light Industrial



LOCATION

Building 310
23515 NW Clara Lane
Suite 140
Hillsboro OR 97124

LEASING CONTACT

Sam Briggs
samb@pactrust.com
503-624-6300

Dave Hicks
daveh@pactrust.com
503-624-6300

TOTAL SQ FT OFFICE SQ FT FEATURES

6,398 SF
958 SF
Great access to Highway 26
Close to Intel

DOCK-HIGH DOORS DRIVE-IN DOORS CLEAR HEIGHT

1
1
20 feet

MONTHLY RATE

\$0.60/sqft - Shell
\$0.90/sqft - Office
NNN

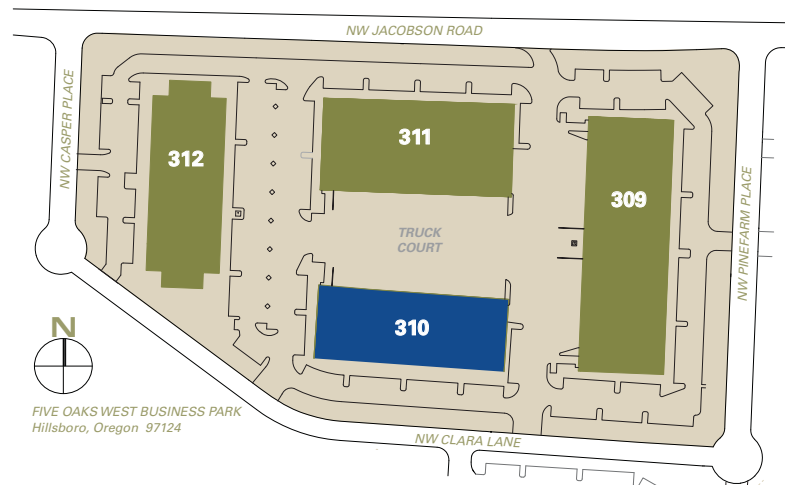

FIVE OAKS WEST BUSINESS PARK

Building 310 • 23515 NW Clara Lane, Suite 140 • Hillsboro OR 97124

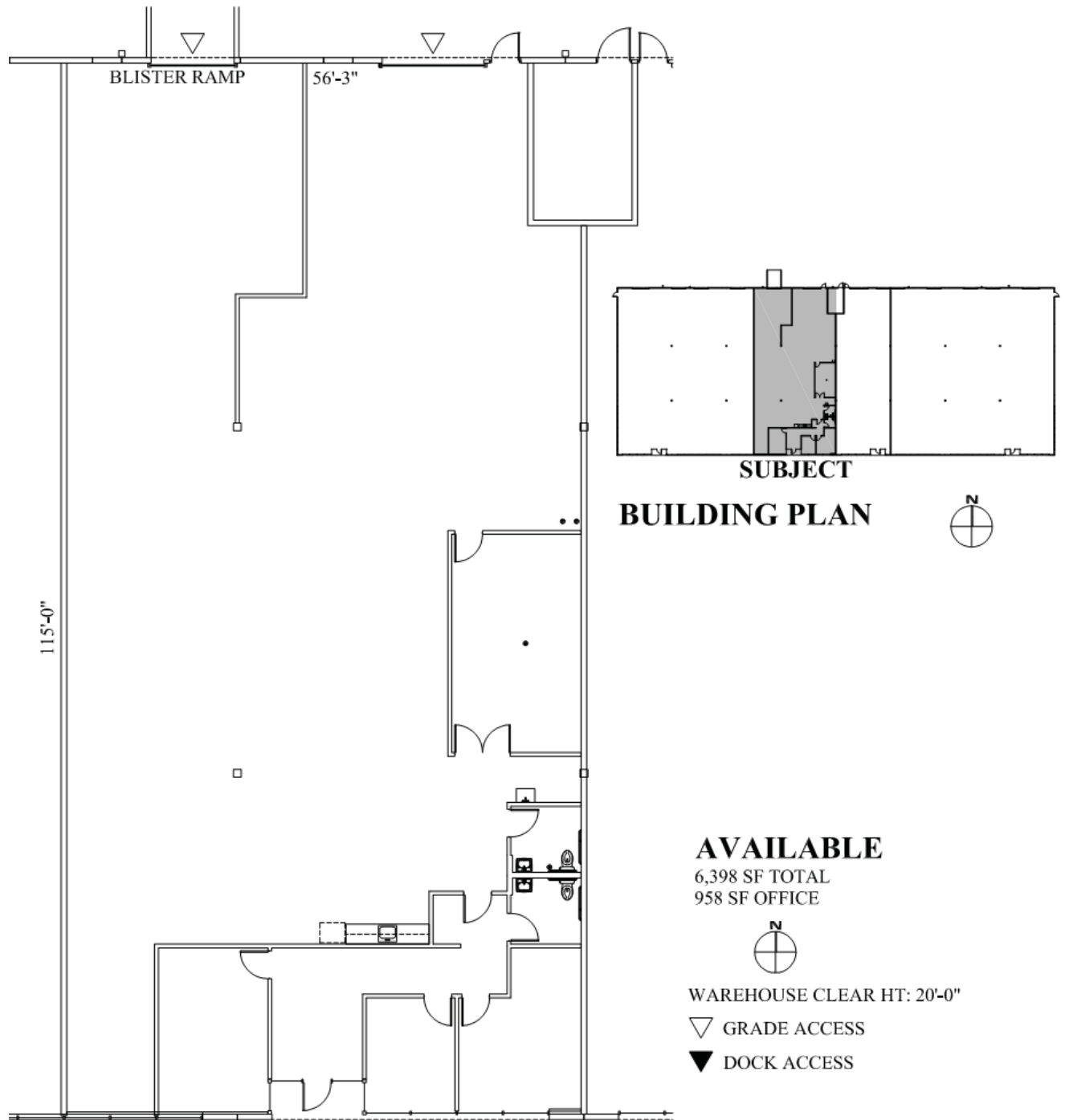

PACTRUST

Pacific Realty Associates, L.P.

15350 SW Sequoia Parkway, Suite 300, Portland OR 97224 • 503-624-6300 • www.pactrust.com

The square footage and rates quoted herein are subject to change. PacTrust can only guarantee square footage and rates with a signed lease agreement.