

INTERNATIONAL CORPORATE CENTER

5,547 Sq Ft Office/Warehouse



LOCATION Building F
11851 NE Glenn Widing Drive
Portland OR 97220

TOTAL SQ FT 5,547 SF
OFFICE SQ FT 3,174 SF
PARKING RATIO 4/1,000

FEATURES End-cap space
Great access to I-205
10 minutes to PDX
Retail, restaurants & services nearby

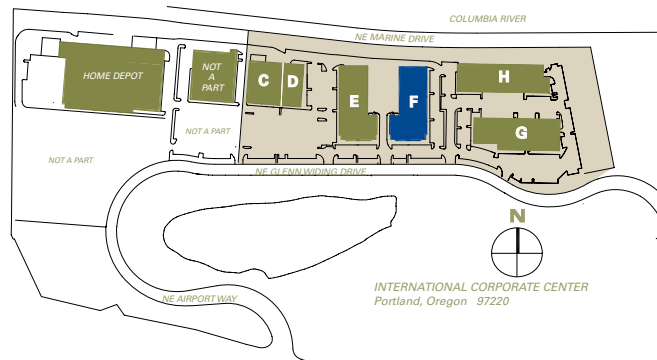

MONTHLY RATE \$0.50/sqft - Shell
\$0.75/sqft - Office
NNN

LEASING CONTACT Matt Krueger
mattk@pactrust.com
503-624-6300

BUILDING KEY

- C. 11719 NE Glenn Widing Drive
- D. 11729 - 11731 NE Glenn Widing Drive
- E. 11815 - 11835 NE Glenn Widing Drive
- F. 11851 - 11879 NE Glenn Widing Drive
- G. 12021 - 12029 NE Glenn Widing Drive
- H. 11909 - 11933 NE Glenn Widing Drive

All addresses are
Portland, OR 97220

INTERNATIONAL CORPORATE CENTER

Building F • 11851 NE Glenn Widing Drive • Portland OR 97220

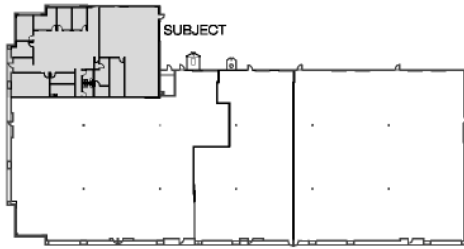

KEY PLAN

AVAILABLE
3,174 SF OFFICE
5,547 SF TOTAL

