

INTERNATIONAL CORPORATE CENTER

21,954 Sq Ft Flex

Divisible



LOCATION
Building G
12029 NE Glenn Widing Drive
Portland OR 97220

FEATURES
End-cap space
Great access to I-205
10 minutes to PDX
Retail, restaurants & services
nearby

TOTAL SQ FT 21,954 SF
OFFICE SQ FT 3,215 SF
DOCK HIGH DOORS 10
DRIVE-IN DOORS 1
CLEAR HEIGHT 18'

MONTHLY RATE
\$0.60/sqft - Shell
\$0.90/sqft - Office
NNN

LEASING CONTACT
Matt Krueger
mattk@pactrust.com
503-624-6300

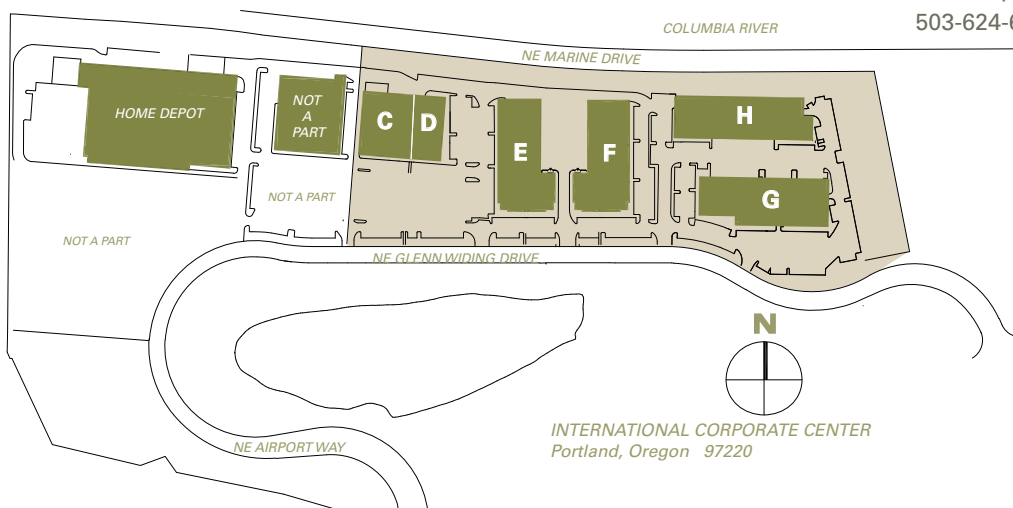

INTERNATIONAL CORPORATE CENTER

Building G • 12029 NE Glenn Widing Drive • Portland OR 97220

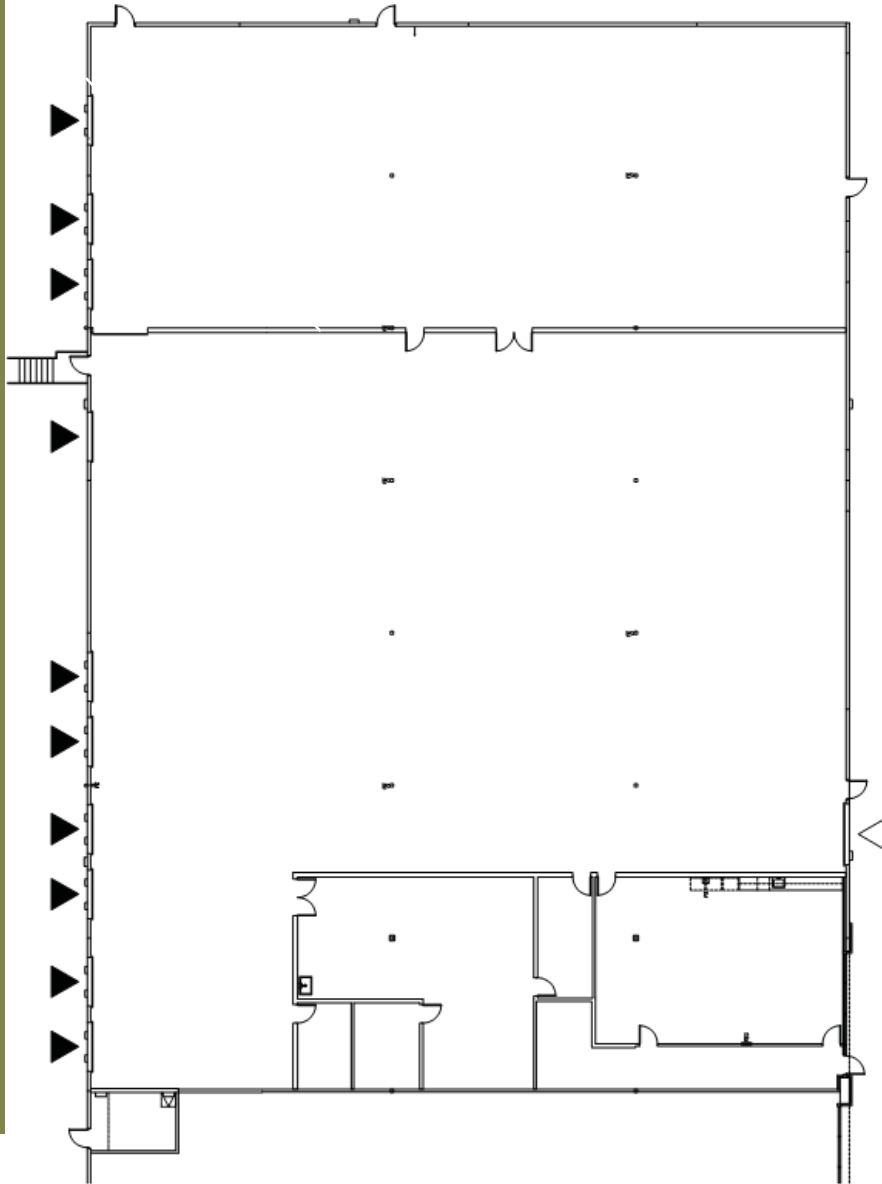

SUBJECT

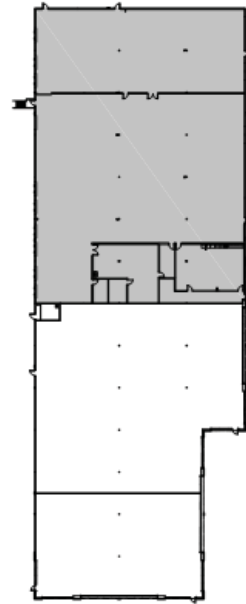

BUILDING PLAN



AVAILABLE

3,215 SF OFFICE
21,954 SF TOTAL



WAREHOUSE CLEAR HT: 18'-0"

▽ GRADE ACCESS

▼ DOCK ACCESS



Pacific Realty Associates, L.P.

15350 SW Sequoia Parkway, Suite 300, Portland OR 97224 • 503-624-6300 • www.pactrust.com

The square footage and rates quoted herein are subject to change. PacTrust can only guarantee square footage and rates with a signed lease agreement.