

# KOCH CORPORATE CENTER

## 42,500 Sq Ft Flex/Industrial



**LOCATION** Building 11  
20700 SW 115th Avenue  
Tualatin OR 97062

**FEATURES** 2.5 miles to I-5

**MONTHLY RATE** \$0.55/sqft - Shell  
\$0.90/sqft - Office  
NNN

**TOTAL SQ FT** 42,500, divisible  
**TOTAL OFFICE SQ FT** Build to Suit

**LEASING CONTACT** Sam Briggs  
samb@pactrust.com  
503-624-6300

**CLEAR HEIGHT** 20'  
**DOCK HIGH DOORS** 11  
**DRIVE-IN DOORS** 4

Dave Hicks  
daveh@pactrust.com  
503-624-6300

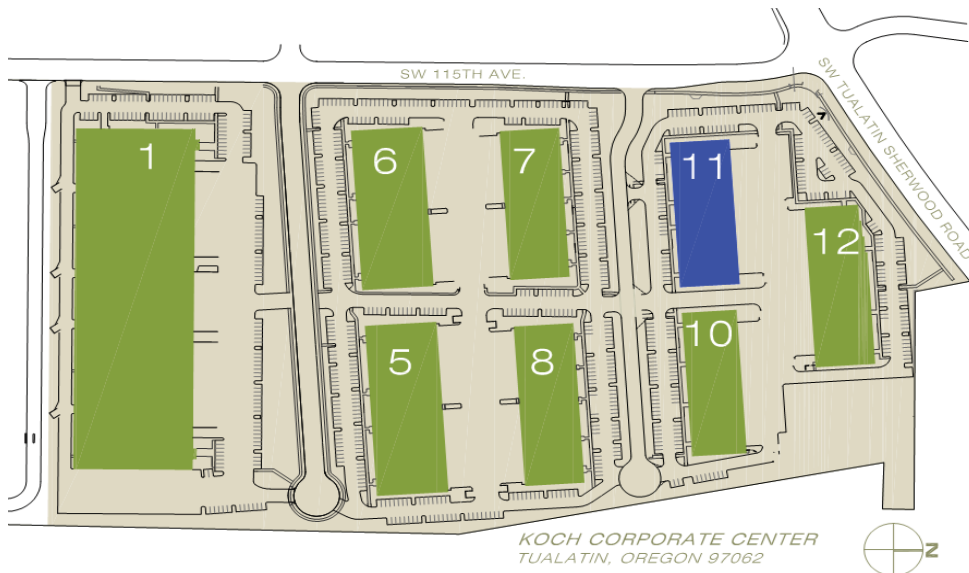

# KOCH CORPORATE CENTER

Building 11 • 20700 SW 115th Avenue • Tualatin OR 97062

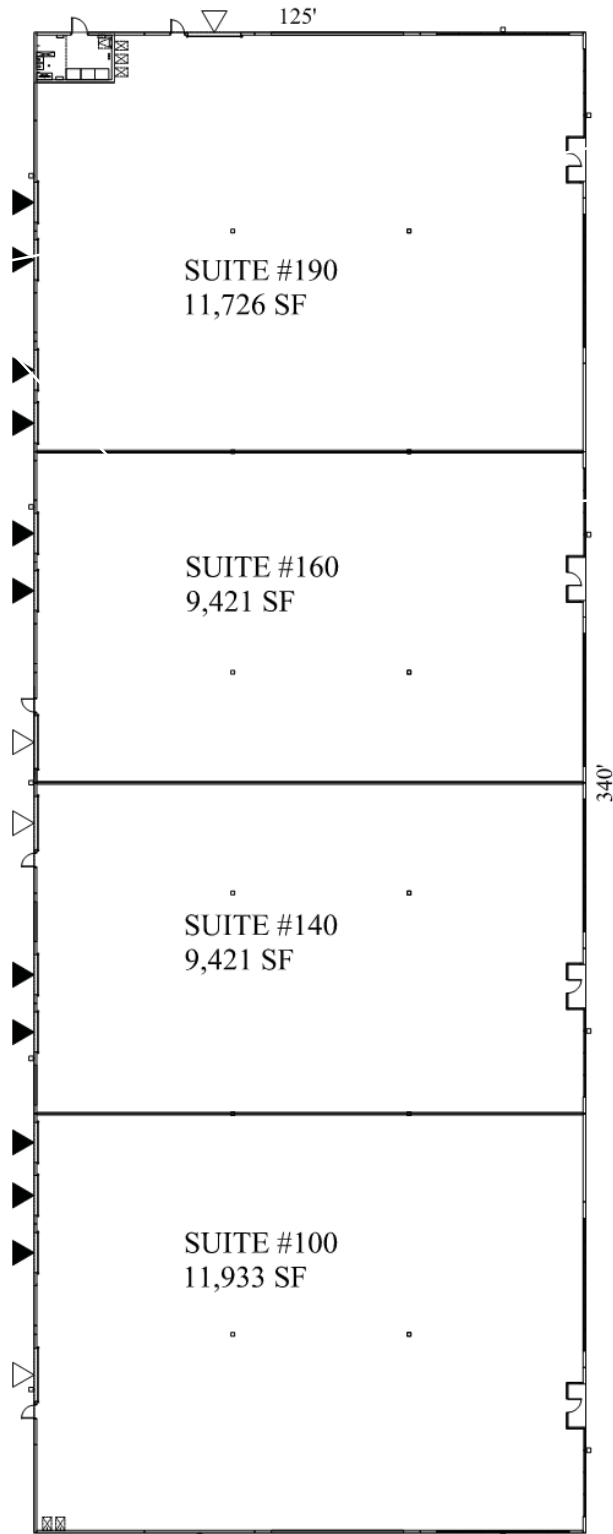

## AVAILABLE

42,500 SF TOTAL  
OFFICE B.T.S.



WAREHOUSE CLEAR HT: 20'-0"

▽ GRADE ACCESS

▼ DOCK ACCESS

SAMPLE DEMISE SHOWN

# PACTRUST

Pacific Realty Associates, L.P.

15350 SW Sequoia Parkway, Suite 300, Portland OR 97224 • 503-624-6300 • [www.pactrust.com](http://www.pactrust.com)

The square footage and rates quoted herein are subject to change. PacTrust can only guarantee square footage and rates with a signed lease agreement.