

KOCH CORPORATE CENTER

45,975 Sq Ft Flex/Industrial



LOCATION Building 12
20600 SW 115th Avenue
Tualatin OR 97062

FEATURES 2.5 miles to I-5

MONTHLY RATE \$0.60/sqft - Shell
\$0.90/sqft - Office
NNN

TOTAL SQ FT 45,975, divisible
TOTAL OFFICE SQ FT Build to Suit

LEASING CONTACT Sam Briggs
samb@pactrust.com
503-624-6300

CLEAR HEIGHT 20'
DOCK HIGH DOORS 12
DRIVE-IN DOORS 3

Dave Hicks
daveh@pactrust.com
503-624-6300

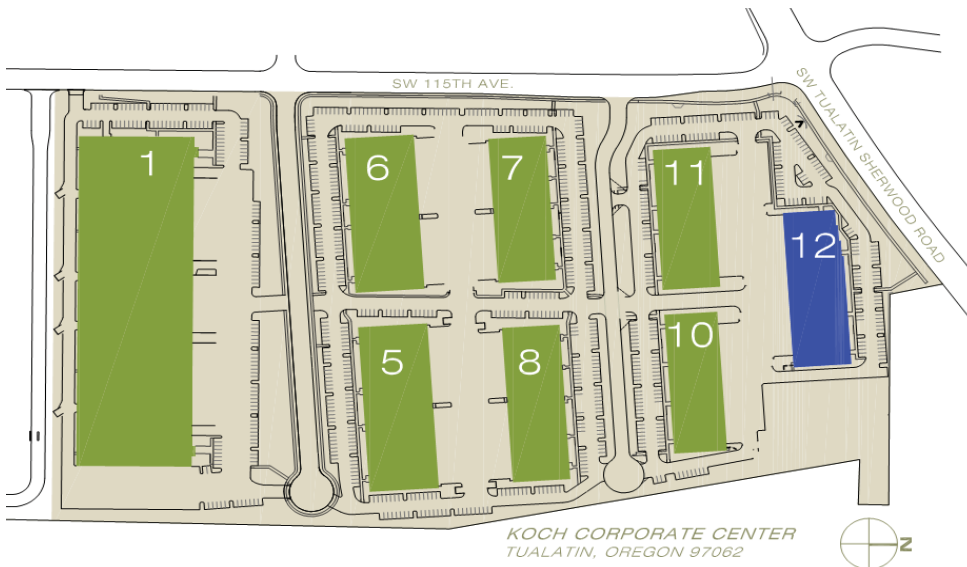

KOCH CORPORATE CENTER

Building 12 • 20600 SW 115th Avenue • Tualatin OR 97062

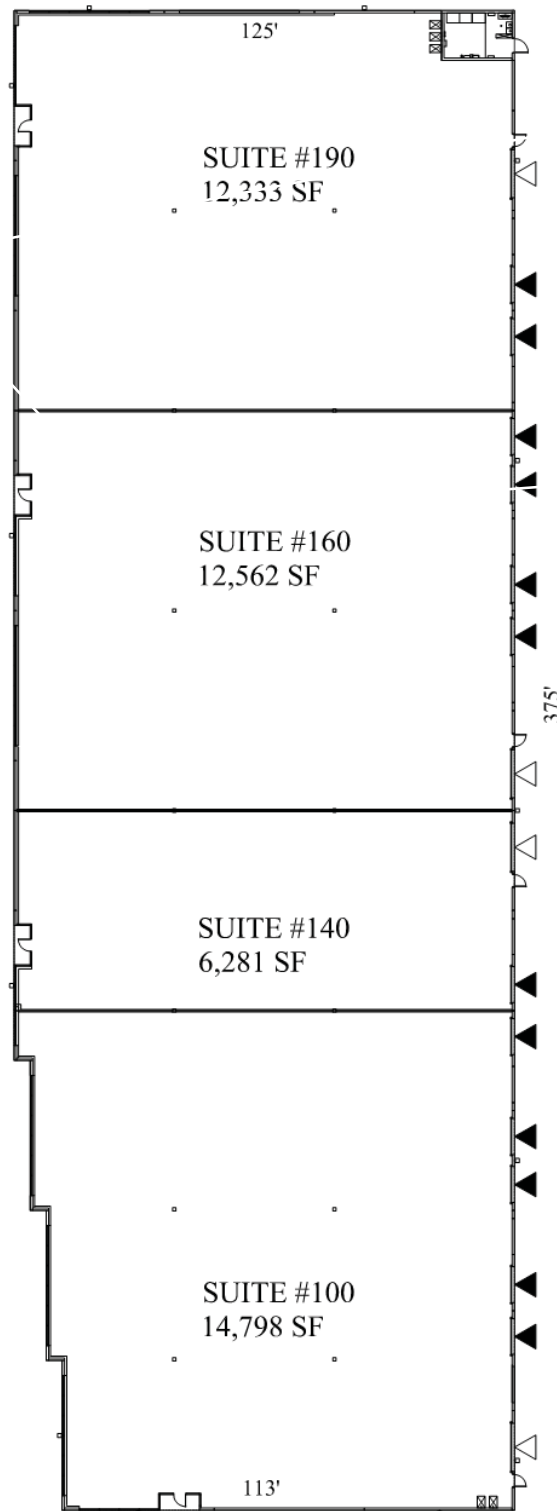

AVAILABLE

45,975 SF TOTAL
OFFICE B.T.S.



WAREHOUSE CLEAR HT: 20'-0"

▽ GRADE ACCESS

▼ DOCK ACCESS

SAMPLE DEMISE SHOWN

PACTRUST

Pacific Realty Associates, L.P.

15350 SW Sequoia Parkway, Suite 300, Portland OR 97224 • 503-624-6300 • www.pactrust.com

The square footage and rates quoted herein are subject to change. PacTrust can only guarantee square footage and rates with a signed lease agreement.