

# OREGON BUSINESS PARK I

## 5,000 Sq Ft Warehouse/Distribution



<b>LOCATION</b>	Building 14 16770 SW 72nd Avenue Portland OR 97224	<b>FEATURES</b>	Excellent freeway access
<b>TOTAL SQ FT</b>	5,000 SF	<b>MONTHLY RATE</b>	\$0.65/sqft - Shell \$0.85/sqft - Office NNN
<b>OFFICE SQ FT</b>	730 SF	<b>LEASING CONTACT</b>	Sam Briggs samb@pactrust.com 503-624-6300
<b>DOCK-HIGH DOORS</b>	4		Dave Hicks daveh@pactrust.com 503-624-6300
<b>DRIVE-IN DOORS</b>	2		
<b>CLEAR HEIGHT</b>	14'		



# OREGON BUSINESS PARK I

Building 14 • 16770 SW 72nd Avenue • Portland OR 97224

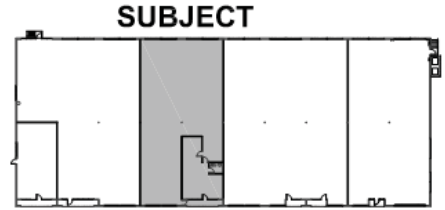
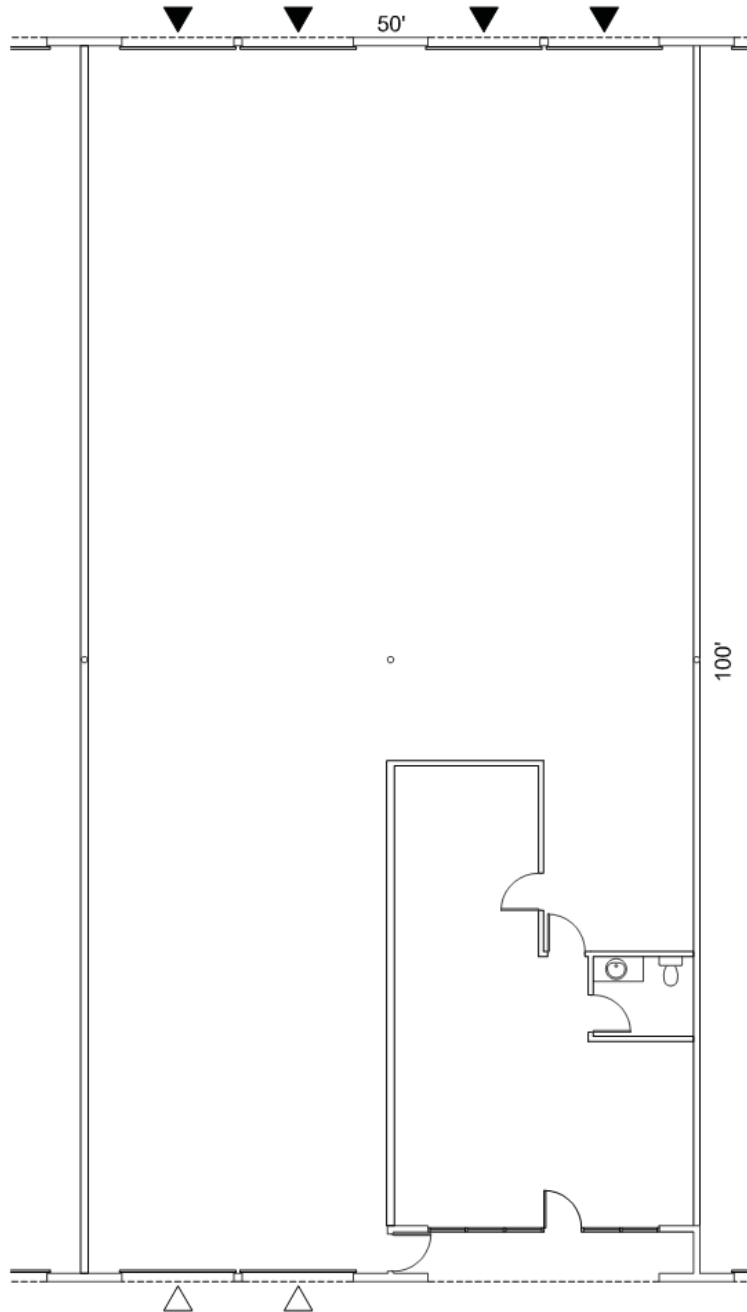

**BUILDING PLAN**



## AVAILABLE

730 SF OFFICE  
5,000 SF TOTAL



▽ GRADE ACCESS

▼ DOCK ACCESS

# PACTRUST

Pacific Realty Associates, L.P.

15350 SW Sequoia Parkway, Suite 300, Portland OR 97224 • 503-624-6300 • [www.pactrust.com](http://www.pactrust.com)

The square footage and rates quoted herein are subject to change. PacTrust can only guarantee square footage and rates with a signed lease agreement.