

OREGON BUSINESS PARK III

1,530 Sq Ft Retail

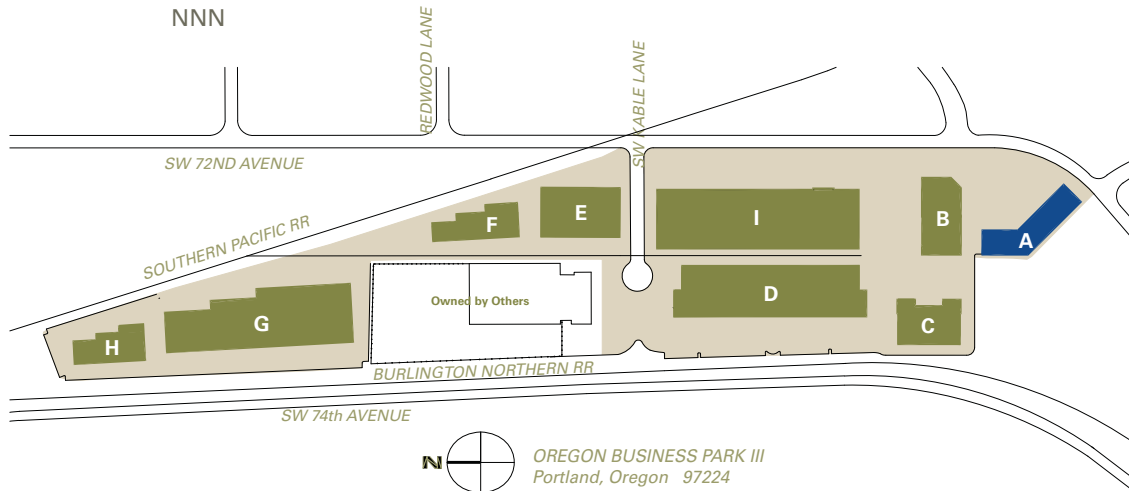

LOCATION	Carmen Center - Building A 15965 SW 72nd Avenue Portland OR 97224	LEASING CONTACT	Sam Briggs samb@pactrust.com 503-624-6300
TOTAL SQ FT	1,530 SF		Dave Hicks daveh@pactrust.com 503-624-6300
FEATURES	Great exposure on SW 72nd Avenue High-traffic shopping plaza		
ANNUAL RATE	\$22.00/sqft NNN		



OREGON BUSINESS PARK III

Carmen Center - Building A • 15965 SW 72nd Avenue • Portland OR 97224

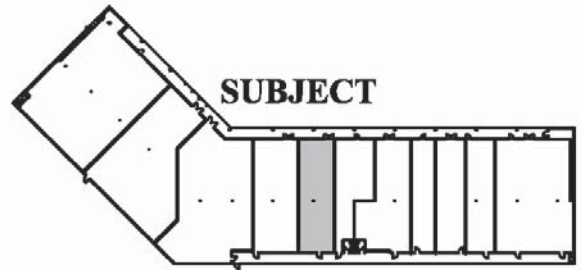
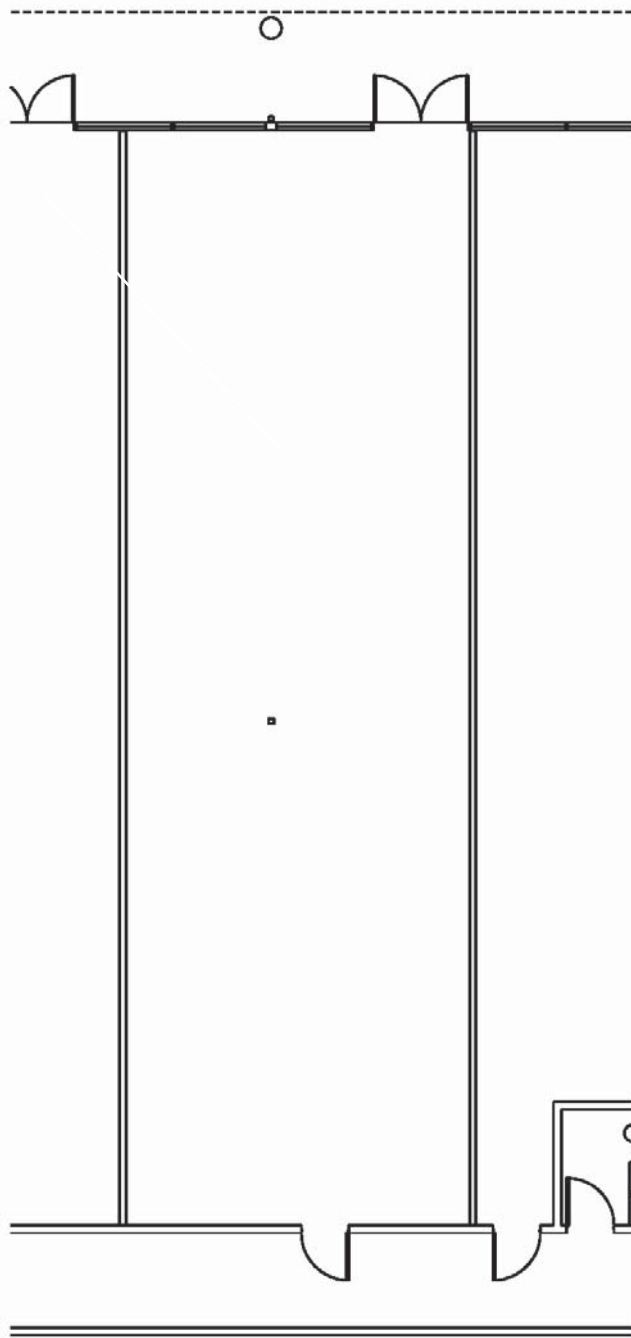

BUILDING KEY PLAN
NOT TO SCALE



AVAILABLE
1,530 SF TOTAL



PACTRUST

Pacific Realty Associates, L.P.

15350 SW Sequoia Parkway, Suite 300, Portland OR 97224 • 503-624-6300 • www.pactrust.com

The square footage and rates quoted herein are subject to change. PacTrust can only guarantee square footage and rates with a signed lease agreement.