

PACIFIC CORPORATE CENTER
SW SEQUOIA PARKWAY, PORTLAND, OR 97224





PACIFIC CORPORATE CENTER

Pacific Corporate Center is located in Portland, Oregon near the Interstate 5 and Highway 217 interchange. It has approximately one mile of frontage on Interstate 5 and is less than 10 miles from Portland's central business district.

Pacific Corporate Center is a mixed-use suburban complex comprised of 20 buildings totaling 602,311 square feet. Class A office and flex/R&D buildings along with retailers can be found here.

Office Depot, Home Depot, Sweet Tomatoes, Umpqua Bank, The Portland Clinic, Flyboy Brewing and BFit Gym are a few of the businesses located in Pacific Corporate Center. A Marriott Courtyard hotel is also located within the park.



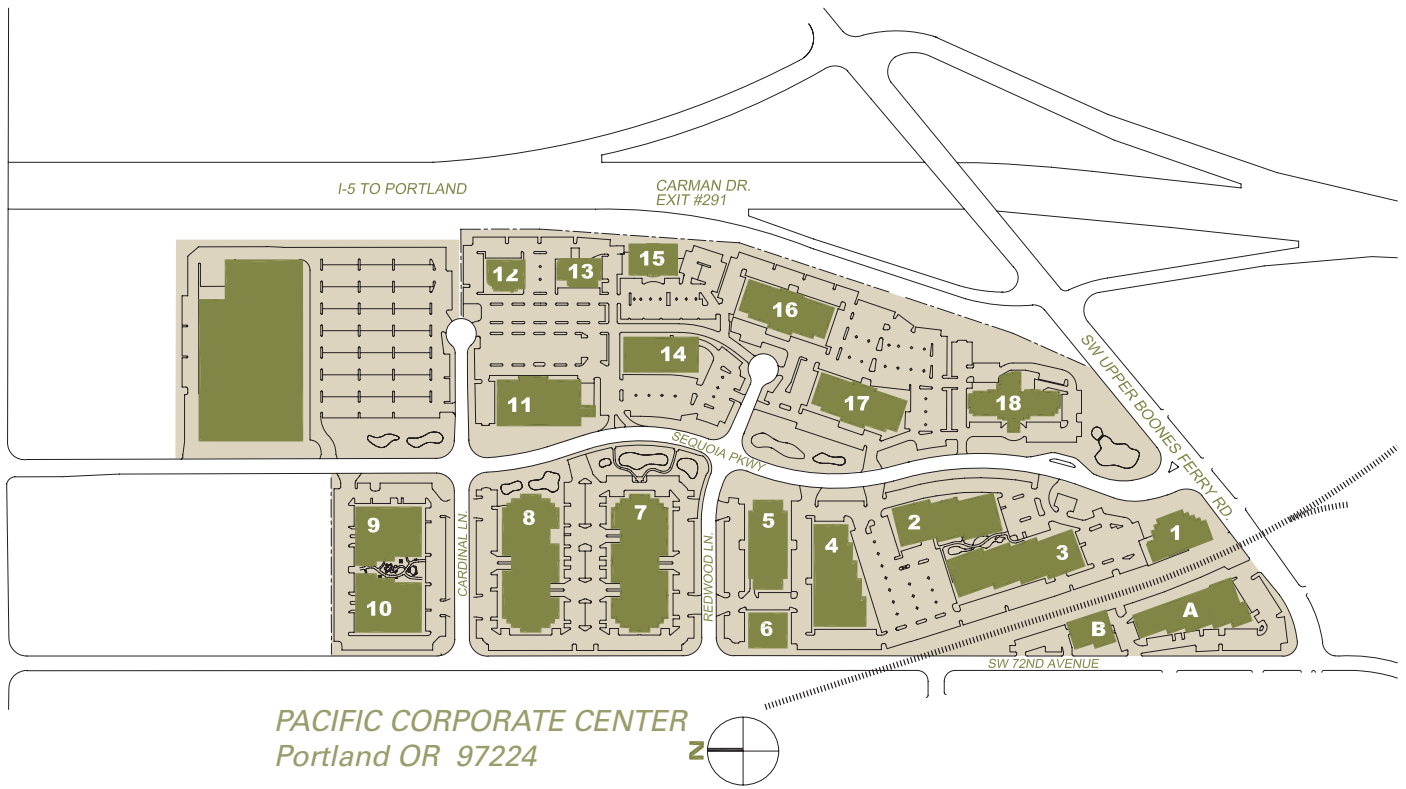

Property Highlights

- 20 buildings totaling 602,311 square feet
- Class A office, flex/R&D and retail
- Frontage along Interstate 5 in Portland, Oregon
- Lush landscaping, walking paths and water features

Area Highlights

- Near I-5 and Hwy 217 interchange
- 10 miles from Portland's central business district
- Retailers and business services onsite
- Near Bridgeport Village shopping center

BUILDING KEY

1. 15755 SW Sequoia Parkway
2. 15495 SW Sequoia Parkway
3. 15575 SW Sequoia Parkway
4. 15353 SW Sequoia Parkway
5. 15333 SW Sequoia Parkway
6. 7000 SW Redwood Lane
7. 15115 SW Sequoia Parkway
8. 15055 SW Sequoia Parkway
9. 14945 SW Sequoia Parkway
10. 7007 SW Cardinal Lane
11. 15060 SW Sequoia Parkway
12. 6600 SW Cardinal Lane
13. 6610 SW Cardinal Lane
14. 15230 SW Sequoia Parkway
15. 6640 SW Redwood Lane
16. 6650 SW Redwood Lane
17. 15350 SW Sequoia Parkway
18. 15686 SW Sequoia Parkway
- A. 15862 SW 72nd Avenue
- B. 15500 SW 72nd Avenue

All addresses are Portland, OR 97224



PACIFIC CORPORATE CENTER



PACTRUST OWNERSHIP & MANAGEMENT

PacTrust is headquartered in Portland, Oregon. We have a strong capital base, conservative leverage and experienced, stable, long-term partners. With over 40 years of proven success in commercial real estate, we are in the unique position of having a team that is dedicated to site selection, design, construction, leasing and property management.

SITE SELECTION

The process of site selection is focused on suitability and sustainability for the long term.

DEVELOPMENT

We have the internal resources to guide a development project from the design phase through construction. This means the quality, durability and flexibility of all buildings can be guaranteed.

LEASING

PacTrust has a team dedicated to helping your business find the space that suits your needs. We work directly with prospective tenants as well as third-party brokers.

PROPERTY MANAGEMENT

In regions where PacTrust has a strong asset base, we operate our own property management function. Currently, there are three property management offices located in:

- Carmel, California
- Portland, Oregon
- Vancouver, Washington

PACTRUST

Pacific Realty Associates, L.P.

15350 SW Sequoia Parkway, Suite 300, Portland OR 97224 • 503-624-6300 • www.pactrust.com